

FAG

6224-2RSR

Deep groove ball bearing

Schaeffler ID:
0390536600000Deep groove ball bearing 62...-2RSR,
single row, seals, steel sheet metal cage

Technical information

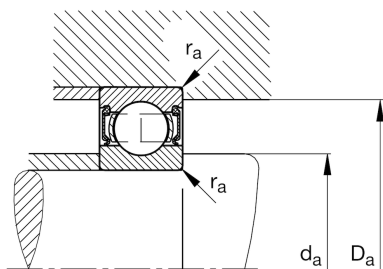
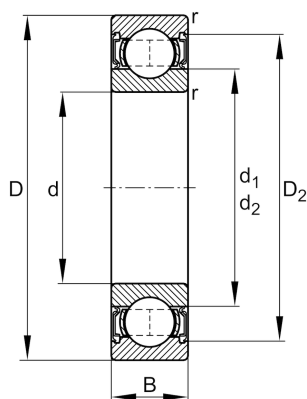
**Main Dimensions & Performance Data**

d	120 mm	Bore diameter
D	215 mm	Outside diameter
B	40 mm	Width
C_r	154.000 N	Basic dynamic load rating, radial
C_{0r}	123.000 N	Basic static load rating, radial
C_{ur}	6.400 N	Fatigue load limit, radial
n_G	1.770 1/min	Limiting speed
	5,689 kg	Weight

Dimensions

r_{min}	2,1 mm	Minimum chamfer dimension
D_2	190,5 mm	Caliber diameter outer ring
d_1	151,1 mm	Shoulder diameter inner ring

Mounting dimensions

$d_{a min}$	132 mm	Minimum diameter shaft shoulder
$D_{a max}$	203 mm	Maximum diameter of housing shoulder
$r_{a max}$	2,1 mm	Maximum fillet radius

Calculation factors

f_0	14,8	Calculation factor
-------	------	--------------------

Temperature range

T_{min}	-20 °C	Operating temperature min.
T_{max}	100 °C	Operating temperature max.